

SECOND FLOOR
DOROTHY HALL

FIRST FLOOR
MEETING ROOM WING

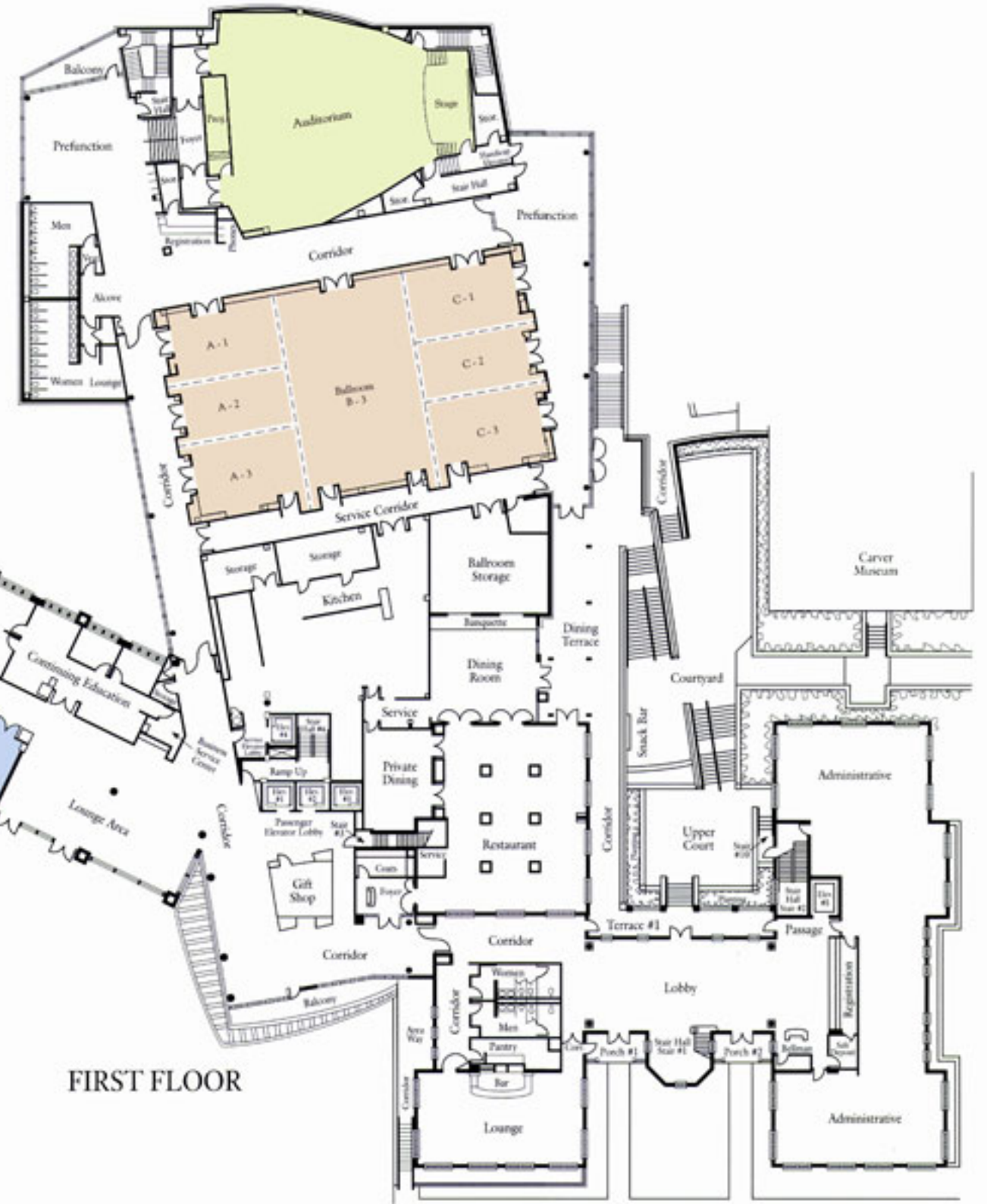

FIRST FLOOR

CONFIGURATIONS & MAXIMUM CAPACITY

Room	Dimensions	Sq. Ft.	Banquet (10's)	Round (8's)	Theatre	Schoolroom	Reception	Conference	Hollow Sq.
BALLROOM	94' x 56'	5,264	450	360	528	320	750	N/A	N/A
Sections A & B	64' x 56'	3,584	300	240	330	200	500	N/A	N/A
Sections B & C	64' x 56'	3,584	300	240	330	200	500	N/A	N/A
Section A	56' x 30'	1,680	100	80	110	84	250	48	48
Section B	56' x 34'	1,904	150	120	168	96	250	48	48
Section C	56' x 30'	1,680	100	80	110	84	250	48	48
Section A1 & A2	35' x 30'	1,050	60	48	77	60	200	40	40
Section A2 & A3	36' x 30'	1,080	60	48	77	60	200	40	40
Section A1	30' x 20'	600	30	24	30	24	60	28	28
Section A2	30' x 15'	450	30	24	30	24	50	28	28
Section A3	30' x 21'	630	30	24	30	24	60	28	28
Section C1 & C2	35' x 30'	1,050	60	48	77	60	200	40	40
Section C2 & C3	36' x 30'	1,080	60	48	77	60	200	40	40
Section C1	30' x 20'	600	30	24	30	24	60	28	28
Section C2	30' x 15'	450	30	24	30	24	50	28	28
Section C3	30' x 21'	630	30	24	30	24	60	28	28
Ballroom Foyer		4,000					575		
AUDITORIUM		3,150			298	298			
Meeting Room A	26' x 23'	598	30	24	40	32	60	24	24
Meeting Room B	26' x 23'	598	30	24	40	32	60	24	24
Computer Lab	26' x 23'	598	N/A	N/A	N/A	15	N/A	N/A	N/A
Meeting Room D	27' x 23'	621	40	32	50	32	65	24	24
Meeting Room E	27' x 23'	621	40	32	40	32	65	24	24
Meeting Room F	26' x 23'	598	40	32	40	32	65	24	24

Room	Dimensions	Sq. Ft.	Banquet (10's)	Round (8's)	Theatre	Schoolroom	Reception	Conference	Hollow Sq.
Meeting Room G	26' x 23'	598	40	32	40	32	65	24	24
COMBINED D & E	53' x 23'	1,219	80	64	80	64	130	48	48
COMBINED F & G	53' x 23'	1,219	80	64	80	64	130	48	48
Conference Room H	23' x 13'	299	10	8	15	12	15	10	N/A
Conference Room I	23' x 13'	299	10	8	15	12	15	10	N/A
Tele-Conference Room	26' x 16'	416	N/A	N/A	N/A	N/A	N/A	15	N/A
Meeting Room Lounge	26' x 23'	598							
Booker T. Washington Board & Conference Room*	39' x 23'	897	N/A	N/A	N/A	N/A	N/A	20	N/A

*Located in Dorothy Hall